



# Profile Select

Liquid Compound



## Product Description

Profile Select Liquid Compound performs best when shaken before use and run at high speed (2000 - 3500rpm). It is a great value, versatile cutting compound aimed at OEM applications.

Used with a G Mop Twisted Wool Compounding Pad, Profile Select quickly removes P800 or finer sanding marks from tooling or production gel coats in a one-step process.

On painted surfaces, used with a G Mop Lambs Wool Pad, it will very quickly remove P1500 sanding marks and leave a good finish which can be enhanced with Profile Finish if desired.

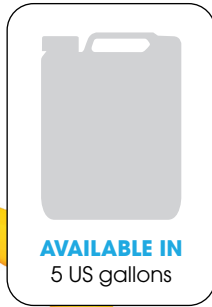

## Product Information

Size	Code	Ctn Qty
1 ltr	<b>PRS101</b>	6
1 US gallon	<b>PRS106</b>	2
5 US gallons	<b>PRS506</b>	1

## Key Benefits

- |                          |   |
|--------------------------|---|
| • Great Value            | New technology gives a high performance at a value price  |
| • Versatile & Swirl Free | Excellent on tooling and production gel coats, painted surfaces and solid surfaces including artificial marble, Corian etc          |
| • One-Step on Gel Coats  | Removes P800 or finer sanding marks in a one-step process on tooling gel coats  |
| • Fast Acting            | Run at <b>HIGH SPEED</b> (2000 to 3500rpm) for a superfast cut on gel coats (Twisted Wool Pad) or painted surfaces (Lambs Wool Pad) |
| • Minimal Throw Off      | Clean in use, pad loads evenly  |



## Use With

### Machine Application



G Mop 8" Twisted Wool Pad - Double Sided  
**GMW806**



G Mop 8" Twisted Wool Pad - Single Sided  
**GMW801**



G Mop Lambs Wool Pad  
**GML301** (3" foam)  
**GML601** (6" foam)  
**GML801** (8" foam)



Adaptor for G Mop 8" Double Sided Wool Pad  
**GMA014** (14mm thread)  
**GMA058** (5/8" thread)  
**GMA016** (16mm thread)



G Mop Flexible Back Plate for 8" Pads  
**GMB814** (14mm thread)  
**GMB858** (5/8" thread)  
**GMB816** (16mm thread)



G Mop Back Plate with Yellow Interface for 6" Pads  
**GMB614** (14mm thread)  
**GMB658** (5/8" thread)  
**GMB616** (16mm thread)

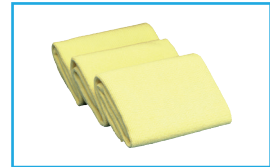

Farécla Finishing Cloth  
**FC-3** (3 x cloths)

## How To Use

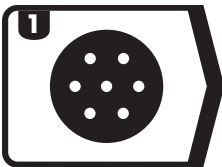

1 Sand area - Profile  
Select removes up to P800

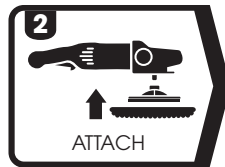

2 Attach G Mop 8" Single Sided Wool Pad to a polisher

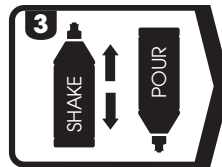

3 Shake well and apply to the pad and surface

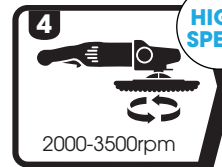

4 Prime pad with product and compound at 2000 to 3500rpm



5 Wipe clean with a Finishing Cloth

\*It is always recommended to test on an inconspicuous area prior to general use

## Technical Information

Appearance: **White liquid**  
Viscosity: **High viscosity**  
VOC Content: **177g/L**  
Relative Density: **1.1**  
pH: **2.4 - 4.5**  
Surface Types: **Tooling and production gel coats, painted surfaces & solid surfaces**

## Additional Information

Clean applicators before and after use with a Spurring Brush to prevent dried product damaging the surface being worked on.



Spurring Brush  
**109005**